

S5114

2004-2005 DODGE RAM 1500, 5.7L/4.7L HEMI
REGULAR CAB & QUAD CAB (SHORT BOX), 3"
CAT BACK, 2.5" DUAL SIDE EXIT

MBRP®

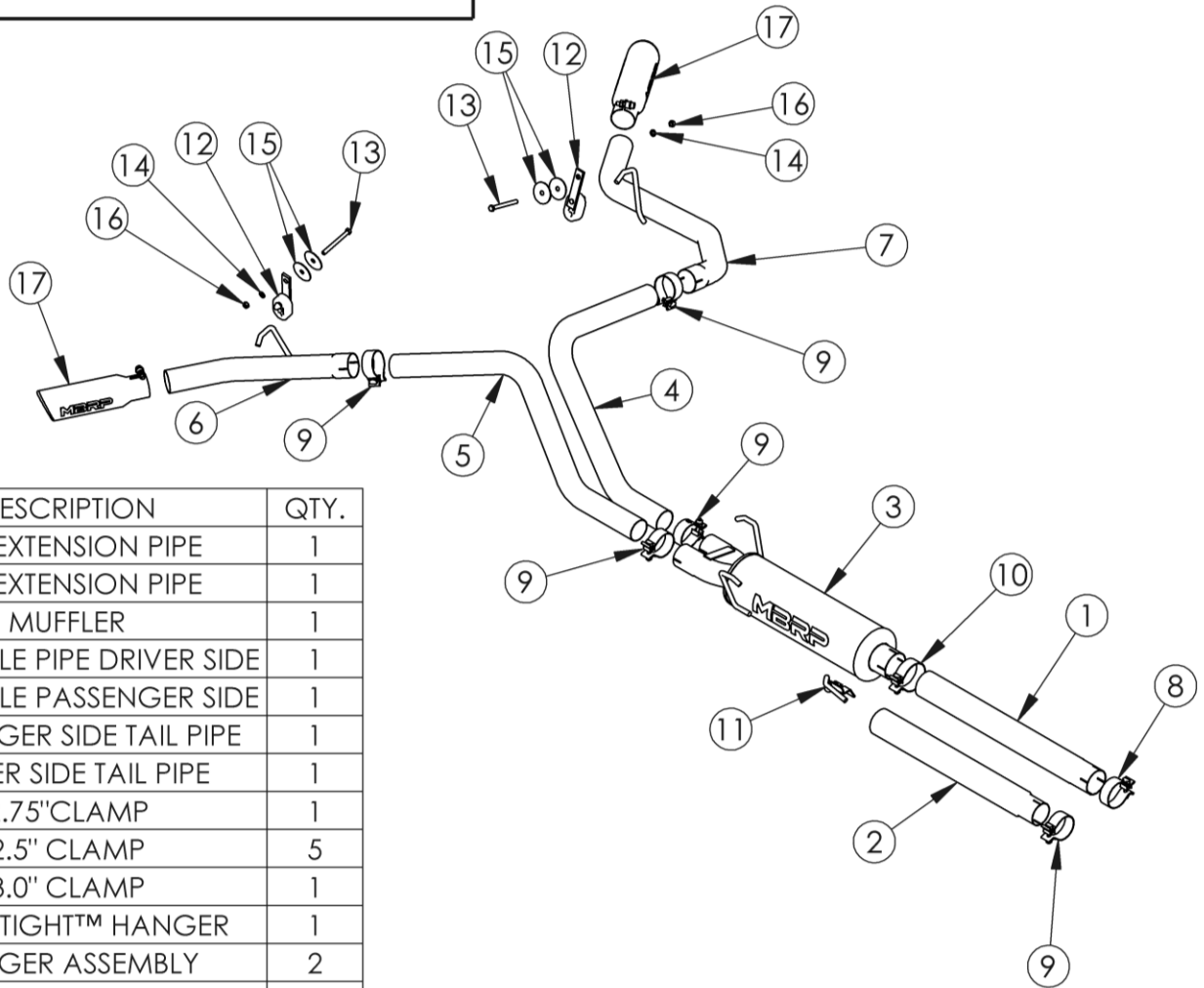

ITEM	DESCRIPTION	QTY.
1	5.7L EXTENSION PIPE	1
2	4.7L EXTENSION PIPE	1
3	MUFFLER	1
4	OVER AXLE PIPE DRIVER SIDE	1
5	OVER AXLE PASSENGER SIDE	1
6	PASSENGER SIDE TAIL PIPE	1
7	DRIVER SIDE TAIL PIPE	1
8	2.75" CLAMP	1
9	2.5" CLAMP	5
10	3.0" CLAMP	1
11	HANG TIGHT™ HANGER	1
12	HANGER ASSEMBLY	2
13	3/8" HEX BOLT X 4"	2
14	3/8" LOCK WASHER	2
15	7/16" FENDER WASHER	4
16	3/8" HEX NUT	2
17	EXHAUST TIP	2

PLEASE READ BEFORE STARTING INSTALLATION

While MBRP has made every effort to ensure that all components of this system are of superior quality and properly packaged, it is the installer's responsibility to ensure the following before removal of the factory exhaust:

- that ALL components shown above are present.
- that ALL mating components fit together.
- that there are no damaged components.
- that the system you have purchased is appropriate for your vehicle year, model and configuration.
- that the system will not interfere with any modifications previously installed or planned.
- that you have read and understand these instructions.

If you have any questions or are uncertain about any aspect of the installation of this system to your vehicle please contact your dealer before commencing installation.



Removal of stock system:

1. Apply a penetrating lubricant liberally to all exhaust fasteners, hangers and rubber insulators.
2. Remove the clamp located behind the muffler. Remove the tail pipe hanger from the rubber insulator and separate the tail pipe from the muffler at the slip joint. Remove the tail pipe from the vehicle.
3. Remove the clamp in front of the muffler and separate the muffler at the slip joint.
4. Remove the hangers from the rubber insulators and remove the muffler assembly from the vehicle.

Installation of MBRP Performance Exhaust:

NOTE: This system does not require the removal of the spare tire.

Quad Cab Models

1. Determine which extension pipe you require for your truck, the **4.7L Extension Pipe** will have a smaller inlet diameter than the **5.7L Extension Pipe**. The 4.7L will require a **2.5” clamp** and the 5.7L requires a **2.75” Clamp**.
2. Install the expanded/reduced (depending on engine size) end of the **Extension Pipe** over the factory exhaust system behind the “Y” pipe and install **Muffler** onto **Extension Pipe** with the **Hang Tight™ Hanger** and **3.0” Clamp** (see figure 1 for Hang Tight instructions) and install into the factory rubber insulator.
3. Place hangers located on **Muffler** into factory rubber insulators.
4. Loosely install the **Driver Side Over Axle Pipe** with a **2.5” Clamp**. This pipe will connect to the outlet closest to the drive shaft.
5. Feed the **Passenger Side Over Axle Pipe** over the axle and install it loosely with a **2.5” Clamp**.
6. Feed the expanded end of the **Driver Side Tail Pipe** from the rear of the vehicle over the axle and connect it to the **Driver Side Over Axle Pipe** with a **2.5” Clamp**.
7. Move the **Driver Side Tail Pipe** into approximate position. Using the factory hole provided in the frame located directly above the tail pipe hanger, attach the hanger provided using the **Hanger Assembly** with the **3/8” Hex Bolt, Lock Washer, Hex Nut** and the **7/16” Fender Washers**.
8. Remove the factory rubber insulator for the factory tail pipe. Now feed the expanded end of the **Passenger Side Tail Pipe** from the rear of the vehicle over the axle and loosely connect it to the **Passenger Side Over Axle Pipe** with a **2.5” Clamp**.
9. Move the **Passenger Side Tail Pipe** into approximate position. Using the factory hole provided in the frame located directly above the tail pipe hanger, attach the hanger provided using the **Hanger Assembly** with the **3/8” Hex Bolt, Lock Washer, Hex Nut** and the **7/16” Fender Washers**.
10. Install the mirror polished **Exhaust Tips**. It is recommended to install them at this point to assist with the final system alignment.
11. Align the edge of band clamp with the edge of the joint it is connecting. Tighten all hardware and clamps, starting at the front and working rearward to secure the system. Check along the full length of the exhaust system to ensure there is adequate clearance for fuel lines, vent lines, brake lines, frame, bodywork, suspension, and any wiring, etc. If there is any interference detected, relocate, or adjust to provide adequate clearance. Ensure all clamp connections are secure and components are unable to rotate or slide. Band clamps require approximately 45 lb-ft (60 N-m) of torque. Verify clearances, system security and band clamp torque after 30- 60 miles (50-100 km) of driving.

Regular Cab Models

1. Temporarily install the **Muffler** by placing hangers located on **Muffler** into factory rubber insulators. Measure from the front of the **Muffler** to the “Y” pipe. This will give you the required length to cut the **Extension Pipe** to. Remove the **Muffler**.
2. Determine which extension pipe you require for your truck, the **4.7L Extension Pipe** will have a smaller inlet diameter than the **5.7L Extension Pipe**. The 4.7L will require a **2.5” clamp** and the 5.7L requires a **2.75” Clamp**.
3. Cut the **Extension Pipe** to the required length. Install the expanded/reduced (depending on engine size) end of the **Extension Pipe** over the factory exhaust system behind the “Y” pipe and install **Muffler** onto **Extension Pipe** with the **Hang Tight™ Hanger** and **3.0” Clamp** (see figure 1 for Hang Tight instructions) and install into the factory rubber insulator.
4. Place hangers located on **Muffler** into factory rubber insulators.
5. Loosely install the **Driver Side Over Axle Pipe** with a **2.5” Clamp**. This pipe will connect to the outlet closest to the drive shaft.
6. Feed the **Passenger Side Over Axle Pipe** over the axle and install it loosely with a **2.5” Clamp**.
7. Feed the expanded end of the **Driver Side Tail Pipe** from the rear of the vehicle over the axle and connect it to the **Driver Side Over Axle Pipe** with a **2.5” Clamp**.
8. Move the **Driver Side Tail Pipe** into approximate position. Using the factory hole provided in the frame located directly above the tail pipe hanger, attach the hanger provided using the **Hanger Assembly** with the **3/8” Hex Bolt, Lock Washer, Hex Nut** and the **7/16” Fender Washer**.
9. Remove the factory rubber insulator for the factory tail pipe. Now feed the expanded end of the **Passenger Side Tail Pipe** from the rear of the vehicle over the axle and loosely connect it to the **Passenger Side Over Axle Pipe** with a **2.5” Clamp**.
10. Move the **Passenger Side Tail Pipe** into approximate position. Using the factory hole provided in the frame located directly above the tail pipe hanger, attach the hanger provided using the **Hanger Assembly** with the **3/8” Hex Bolt, Lock Washer, Hex Nut** and the **7/16” Fender Washer**.
11. Install the mirror polished **Exhaust Tips**. It is recommended to install them at this point to assist with the final system alignment.
12. Align the edge of band clamp with the edge of the joint it is connecting. Tighten all hardware and clamps, starting at the front and working rearward to secure the system. Check along the full length of the exhaust system to ensure there is adequate clearance for fuel lines, vent lines, brake lines, frame, bodywork, suspension, and any wiring, etc. If there is any interference detected, relocate, or adjust to provide adequate clearance. Ensure all clamp connections are secure and components are unable to rotate or slide. Band clamps require approximately 45 lb-ft (60 N-m) of torque. Verify clearances, system security and band clamp torque after 30- 60 miles (50-100 km) of driving.

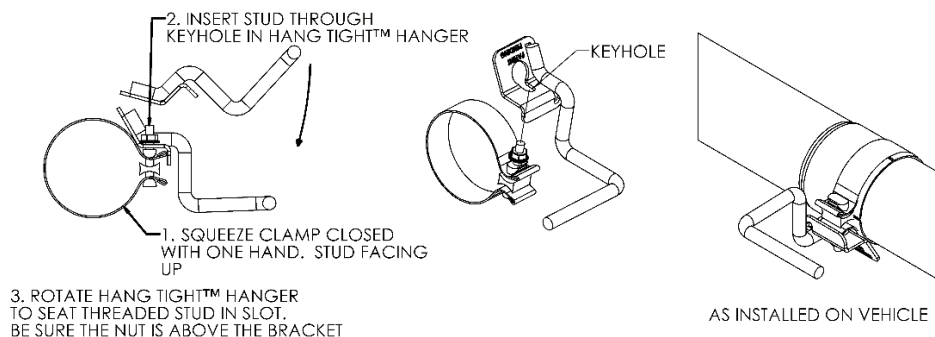

Figure 1 (Hang Tight™ Hanger not exactly as shown).

Congratulations! You are ready to begin experiencing the improved power, sound and driving excitement of your **MBRP** performance exhaust system. We know you will enjoy your purchase.